



**The Novasub Bullet color LED-ring camera is a low cost mini robust underwater color video camera with a fixed wide angle lens and a built-in LED-ring.**

The Novasub NSBCL video camera is a stainless steel housed low cost mini robust underwater color video camera with internal LED-ring and a 3.6 mm lens. The 3.6 mm lens gives a 62 deg. openings angle underwater which is ideal to come close to the object in poor visibility water.

The built-in LED-ring consists out of 6 high bright LED's and power on when camera is powered. The LED-ring is designed for close-up lighting which fits ideal with the camera. The camera has on the back an indent which can be used to clamp the camera to a support using a jubilee clip. The video signal output is standard a video signal transmission over twisted pair using a built-in video line driver which makes it possible to run the video signal over 600 m of twisted pair cable. Also the NSBCL can be supplied with a standard composite video output.

## Features

- Small housing
- Extreme ruggedized
- Internal LED ring

## Applications

- Fixed installations
- Drop down systems
- ROV systems
- CCTV systems

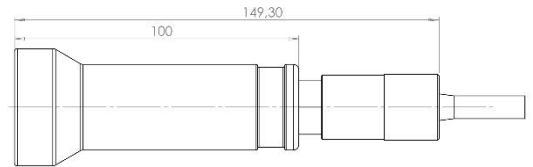
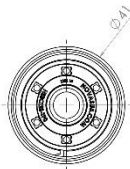

Model	NSBCLSSB	NSBCLSSD	NSBCLSSC	NSBCL SSE
Image Pick-up Device	1/3" 960H SONY EXview HAD CCD II		1/3" SONY Super HAD CCD II	
Horizontal Resolution	700 TVL		550 TVL	
Effective Pixels	PAL: 976(H) X 582(V) (Total: 1020(H) X 596(V))		PAL: 752(H) X 582(V) (Total: 795(H) X 596(V))	
Scanning System	2:1 Interlace			
Sync System	Internal			
Electronic Shutter Time	PAL: 1/50 ~ 1/100,000 sec			
Usable Illumination	0.1 Lux		0.05 Lux	
Lens	3,6mm	2,97 mm	3,6mm	2,97 mm
Field of View (FOV) underwater	62°	80°	62°	80°
Video Output	TP: Video line drive (over twisted pair) or C: 1.0Vp-p 75 ohm (coax)			
Gain Control(AGC)	Auto			
Power Supply	10-36 vdc 150mA			
Dimensions	100 mm x ø 41 mm (excl. Connector)			
Material Housing	SS 316		SS 316	
Weight	400 gr. (In air), 340 gr. (In water)		400 gr. (In air), 340 gr. (In water)	
Operating Depth	300 m		300 m	
Connector	Standard: MCBH4MSS    Optional: MCBH3M, SCBH4M, SCBH3M - pin layout: 0 : 1=-,2=+,3=vid+,4=Vid- 1 : 1=Vid,2=-/VidGnd,3+= 2 : 1=-,2=+,3=Vid,4=VidGnd			
Connection for mounting	Jubilee clip groove			
LED-ring	6x High Brite LED's total 72 lumen, at a distance of 20 cm from cam. 1800 lux of light at 6500 K			
Operating Temp.	In water -10°C - +40°C			
Optional lens	3-6-8-12 mm (FOV underwater 85°, 40°,30°,21°)			

## Related Products:

- Ball bracket
- Novasub SCC/SCB/SCU Control/DVR units
- Novasub LED lights
- Novasub Cables/Diver Umbilical's

## Distributed by: