



## Single Stage, Six-Port configuration High Pressure regulator.

A high pressure, high flow regulator with excellent performance, capable of the largest flowrate in its class, with 2000 LPM @ 20 Bar. The HPREG2000-20 single-stage design ensures accurate pressure control of the cylinder, during the product lifecycle.

A high pressure, single stage piston cylinder regulator is suitable for primary pressure gas control of non-corrosive or toxic, high purity gases up to grade 6.0 purity (99.9999%).

### Features

- Nickel plated brass bar stock body;
- O<sub>2</sub> suitable;
- Six port configuration;
- High pressure high purity (up to grade 6.0) gases;
- Panel mounting nuts available.

### Specifications

Type	: Single-stage
Inlet Pressure	: 300 Bar (4350 PSI) or 230 Bar (3335 PSI)
Outlet Pressure	: 0-20 Bar
Temperature Range	: -20°C to +60°C (-4° to + 140° F)
Max. flowrate	: 200 m <sup>3</sup> /hr. @21°C in Air at 300 (230) Bar Inlet
Weight	: 1,4 kg (3.1lb)
Materials	
Body	: Nickel plated brass
Valve seat	: PCTFE
Diaphragm	: 316L Stainless steel
Inlet & outlet Connections	: 1/4" NPT

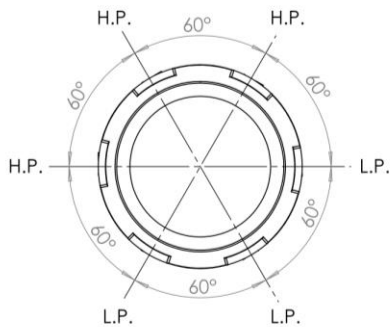

100 bar Inlet Pressure @21° C

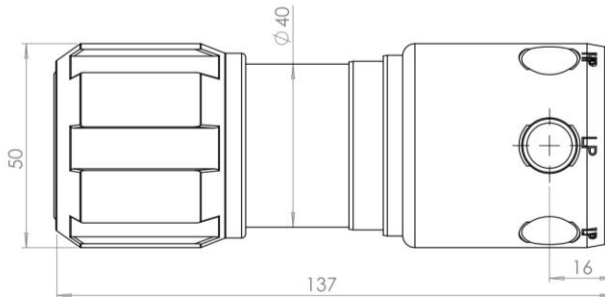
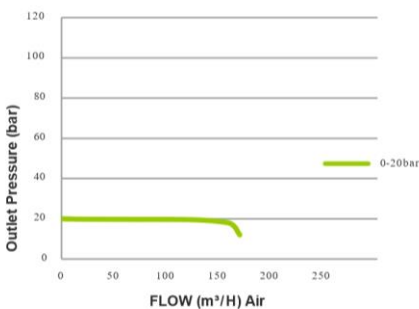

200 bar Inlet Pressure @21° C

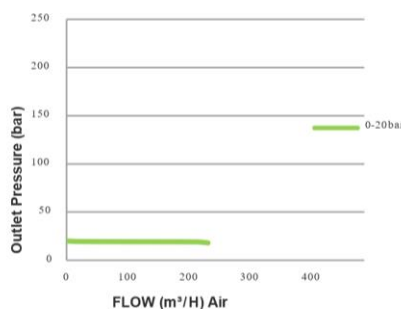

300 bar Inlet Pressure @21° C

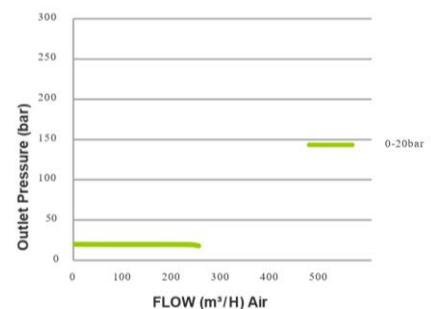

### Related Products:

- Diver gas panels

### Distributed by: